



Beck Crescent
Loughborough, LE11 2UT

£950 pcm

Property Features

- DETACHED HOUSE
- GARAGE
- ENSUITE
- 18FT KITCHEN DINER
- CLOSE TO THE OUTWOODS
- THREE BEDROOMS
- OFF ROAD PARKING
- DOWNSTAIRS W.C
- 18FT LOUNGE
- CLOSE TO WOODBROOK VAL F

Full Description

This IMMACULATE DETACHED FAMILY HOME sits on a modern development on the outskirts of the countryside, with WALKS UP TO THE OUTWOODS on your doorstep. Internally there are THREE BEDROOMS, master en suite, family bathroom, 18FT LOUNGE, 18FT KITCHEN DINER and downstairs w.c. Externally there are well maintained gardens, DRIVEWAY AND DETACHED GARAGE.

ENTRANCE HALL

Door into entrance hall with stairs off to first floor, under-stairs storage cupboard, radiator, laminate flooring and doors to downstairs W.C. kitchen/diner and lounge.

KITCHEN/DINER

18' 3" x 9' 0" (5.56m x 2.74m)

Fitted with a range of wall, base and drawer units with laminate work surfaces, stainless steel one and a half bowl sink drainer, integrated electric oven, built in gas hob, integrated for fridge freezer, integrated washing machine, radiator, integrated dishwasher, laminate flooring, PVCu double glazed window to front elevation and PVCu double glazed french doors to outside.

LOUNGE

18' 4" x 10' 3" (5.59m x 3.12m)

PVCu double glazed window to front elevation, PVCu double glazed window to side elevation and radiators.

DOWNSTAIRS W.C.

Fitted with a two piece suite comprising close coupled W.C. and wash hand basin, PVCu double glazed window to rear elevation and radiator



LANDING

PVCu double glazed window to rear elevation, access to airing cupboard, Doors to bedroom one, bedroom two, bedroom three and bathroom.

MASTER BEDROOM

18' 4" x 8' 5" (5.59m x 2.57m)

PVCu double glazed window to front elevation, radiator, built in wardrobes and door to en suite.

EN SUITE

Fitted with a three piece suite comprising close coupled W.C., pedestal wash hand basin and shower cubicle, ladder style radiator and PVCu double glazed window to rear elevation.

BEDROOM TWO

9' 7" x 9' 1" (2.92m x 2.77m)

PVCu double glazed window to front elevation and radiator.

BEDROOM THREE

9' 0" x 6' 2" (2.74m x 1.88m)

Fitted wardrobes, PVCu double glazed window to side elevation and radiator.

BATHROOM

Fitted with a three piece suite comprising close coupled W.C., pedestal wash hand basin and bath with shower over, ladder style radiator and PVCu double glazed window to rear elevation.

GARAGE

Detached garage with up and over door powered with a remote control, light and electricity.

OUTSIDE

To the front of the property is a large lawn area with concrete path to front door and shrub boarder. To the rear of the property is driveway and access to detached garage. To the side of the property is a enclosed lawn garden with concrete path, shrub area and access gate to garage and driveway.

Viewing Arrangements

Please contact Clare, Stef, Hannah or Becky to arrange your viewing.



Internal photographs

It should not be assumed that items shown in our photographs are included in the let of the property.

Measurements

Although we have taken every care to ensure the dimensions for the property are true, they should be treated as approximate and for general guidance only.

General Note

These details and floor plans, although believed to be accurate, are for guidance only and prospective tenants should satisfy themselves by inspection or otherwise to their accuracy. No individual within this letting agency has the authority to make or give any warranty in respect to the property.

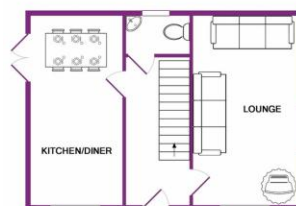

GROUND FLOOR

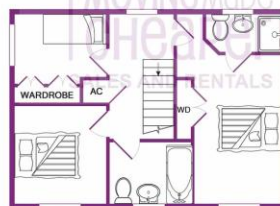

1ST FLOOR

